

Cub 4s Carry-On

3 968 lb Portable Winch



PN 123930 12V

Features Include

- Sealed highly efficient low amp draw permanent magnet motor.
- Lightweight and compact design.
- Centre drum winch provides better support, handles side loading, increases strength and performance.
- Mechanical and dynamic brakes for 100% loadholding.
- Cam activated free-spool clutch for rapid wire rope payout.
- Dyneema SK-75 12-strand construction synthetic rope, coated to improve abrasion resistance and protect from the ingress of dirt and grit.
- Submersible, sealed contactor handles high amps and allows higher duty cycle.

Specifications

- Rated line pull: 1 814 kg single line.
- Line speed (1st layer): 6 mpm 15 amps at no load.
2.0 mpm 230 amps at full load.
- Motor: 800 w / 1 hp 12V permanent magnet.
- Gear ratio: 3-stage planetary 191:1
- Clutch (free-spooling): Sliding pin and ring gear.
- Brake (outside the drum): Mechanical spring applied and dynamic brakes (*written as motor in initial pdf. which?*)
- Winch construction: Aluminum die-cast drum and housings.
- Drum size: 55 x 104 x 119 L
- Control: Remote control w/ 3 m cord.
- Rope: Dyneema Synthetic SK-75
- Size: 5.5 mm x 15.2 m
- Mounting bolts pattern: 168 mm x 76 mm
- Std Compliance: CE Machinery Directive 2006/42/EC
CE EMC Directive 2004/108/EC

Line Pull and Rope Capacity

| ROPE LAYER | PULL BY LAYER (KG / LB) | TOTAL ROPE ON DRUM (M) |
|------------|-------------------------|------------------------|
| 1 | 1 814 / 4 000 | 4.0 |
| 2 | 1 535 / 3 385 | 8.8 |
| 3 | 1 331 / 2 933 | 14.2 |
| 4 | 1 174 / 2 588 | 15.2 |

| LINE SPEED & AMP DRAW (1st Layer of Rope on the Drum) | | |
|--|------------------|----------------|
| LINE PULL (KG / LB) | LINE SPEED (MPM) | AMP DRAW (12V) |
| No Load | 6.0 | 15 |
| 454 / 1 000 | 3.4 | 70 |
| 907 / 2 000 | 2.9 | 120 |
| 1 361 / 3 000 | 2.4 | 180 |
| 1 814 / 4 000 | 2.0 | 230 |

Dimensions mm/inch

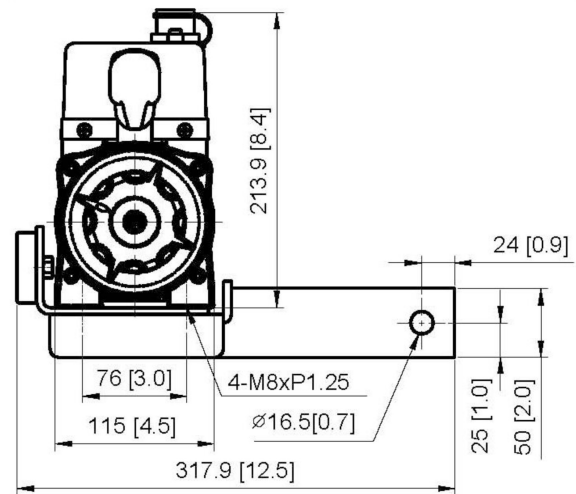
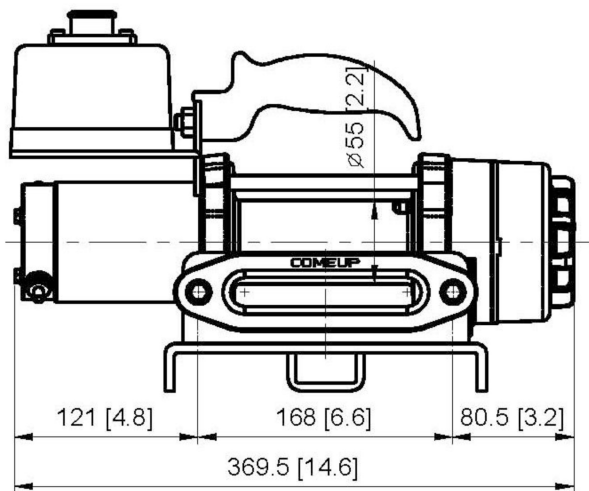

Packaging

- Winch Weight (including rope): 12.2 kg
- Gross Weight: 19.1 kg
- Box Dimensions: 410 x 200 x 345 mm

Accessories

- Synthetic rope 5.5 mm x 15.2 m w/clevis hook
- Remote control w/ 3 m cord
- Hawse fairlead
- Mounting hardware
- Control box w/handle
- 2" rear receiver
- Quick connector wiring kit

WARNING!

- Do not use winch to transport, lift or otherwise move personnel.
- The rated line pull shown is based on the first layer of wire rope on the drum.
- The wire rope must remain on the drum at all time with at least 10 wraps.

Warranty

Limited lifetime warranty for mechanical components and one(1) year warranty for electrical components from date of purchase. Wire/Synthetic ropes are not included under warranty.